

CKC-1007-2



CKC-7-3(C)



CKC-7-3(P)



CKC-1007-2  
CKC-7-2

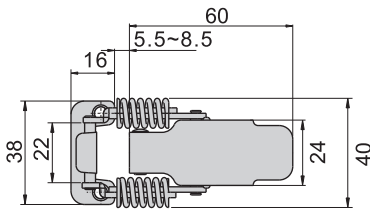

CKC-1007-3  
CKC-7-3

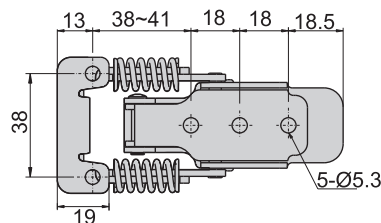
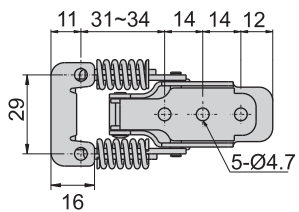
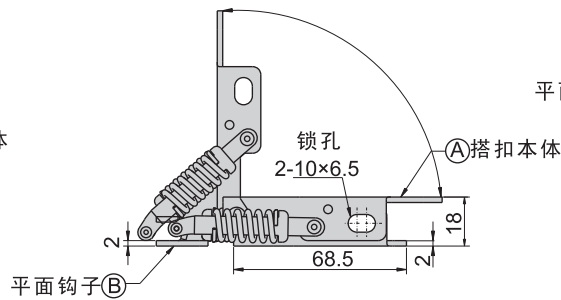
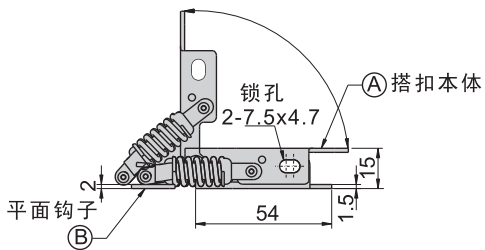
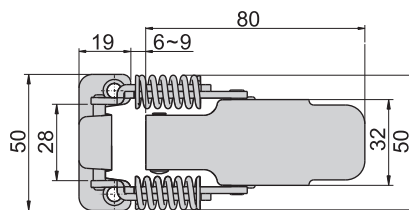

(使用例: 立体图示)

平面式的上钩

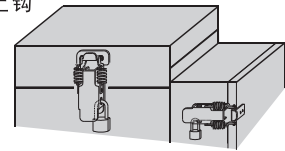

垂直式的钩子

双扣

材 质	CKC-1007、CKC-1017---不锈钢 (SUS 304)
	CKC-7、CKC-17---铁
表面处理	CKC-17---镀锌
	CKC-7---(C)镀锌 (P)砂面黑色耐刮面