

CE-426-A(B)



CE-426-B(B)



CE-426-D(B)



CE-426-E(B)



CE-426-F(B)



CE-426-G(B)



CE-426-K(B)



CE-426-Y(B)



凸四角8m/m
A

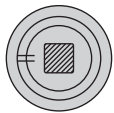

凸三角7m/m
B



双凹型5m/m
D

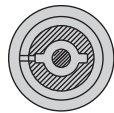

凹六角8m/m
E

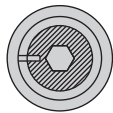

凹四角8m/m
F

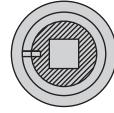

一字型
G

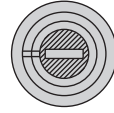

空心8m/m
K

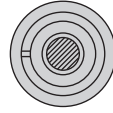

凸六角8m/m
Y

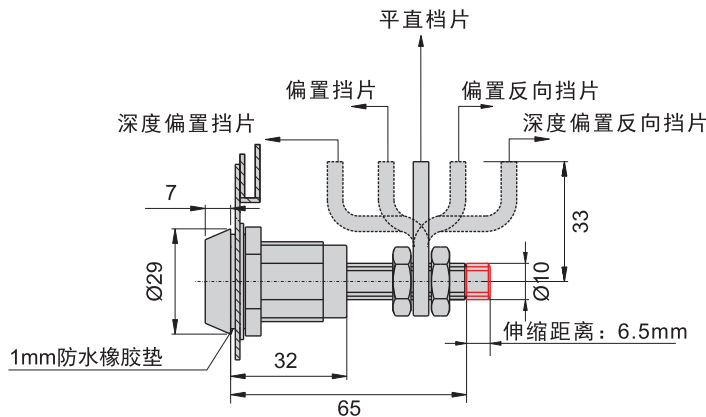
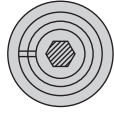

开孔尺寸图

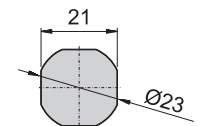

E3-5-15 (CE-426-K用钥匙)

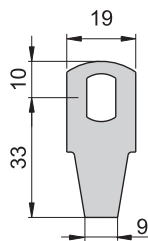
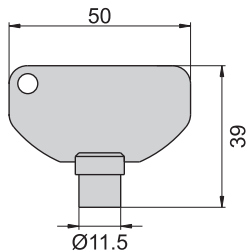

E33-1

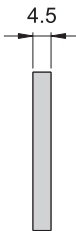

E33-2

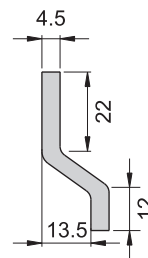

E33-3

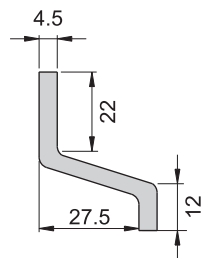

材 质	锌合金(ZDC)
表面处理	(S) 镀铬-光面 (B) 砂面-黑色耐刮面
特 征	挡片可自由调整至关门迫紧时适当之松紧程度。
备 注	钥匙C-406-H (长), C-406-H-2 (短) 详见P32。 CE-426-K钥匙---E3-5-15 钥匙需另外购买。